

6MP Fisheye Network Camera

The 360° panoramic camera with high-definition image-capturing capability adopts an ultra-wide-angle lens. It can shoot 360° panoramic views, achieving blind-spot-free monitoring. It supports multiple output modes and bit rate settings, adapting to different requirements for image quality and fluency in various scenarios. The device is equipped with high-efficiency infrared lights for 360° omnidirectional light compensation. The irradiation distance can reach up to 5 meters, enabling real-time day and night monitoring. It is widely used in the CCTV monitoring of the rail transit industry.

- High quality imaging with 6MP resolution.
- Efficient infrared lamps with a long service life, providing 360° all-round supplementary lighting.
- Smooth bitstream settings to adapt to different scenarios.
- Clear imaging against strong back light based on 120 dB WDR technology.
- Water and dust resistant (IP66) and vandal resistant (IK10).



Technical Parameters

Items	Specification
Camera	
Sensor	1/1.8" Progressive Scan CMOS
Min. Illumination	0.1 Lux @ (F1.2, AGC ON), 0.001 lux with IR

Shutter Speed	1/25 s to 1/100,000 s
Focal Length	1.27mm, F2.6
Wide Dynamic Range (WDR)	120 dB
Day & Night	IR Cut Filter

Video

Max. Resolution	3072×2048
Video Compression	H.265 / H.264 / MJPEG
H.264 Type	Baseline Profile / Main Profile / High Profile
H.265 Type	Main Profile
Image Settings	Support rotation mode. Brightness, contrast, saturation and sharpness can be adjusted by browser and client software.
Stream Type	Main stream, Sub-stream
Main Stream	50Hz: 25fps (3072×2048, 2048×2048, 1280×1280) 60Hz: 30fps (3072×2048, 2048×2048, 1280×1280)
Sub-stream	50Hz: 25fps (720×720) 60Hz: 30fps (720×720)
Video Bit Rate	32 Kbps~16Mbps

Audio

Audio Compression	G.711, G.722.1, G.726, MP2L2, PCM, ACC
Audio Bit Rate	64Kbps (G.711) / 16Kbps (G.722.1) / 16Kbps (G.726) / 32-160Kbps (MP2L2) / 16-64Kbps (ACC)
Audio Sampling Rate	8/16 kHz

Network

API	ONVIF (PROFILE S/G/T)
Protocols	TCP/IP, ICMP, HTTP, HTTPS, FTP, DHCP, DNS, DDNS, RTP, RTSP, RTCP, PPPoE, NTP, UPnP, SMTP, SNMP, IGMP, 802.1X, QoS, IPv6, UDP, Bonjour

General

Protection Level	IK10 / IP66
Operating Conditions	-30 °C to 60 °C, humidity less than 95% (non-condensing)
Ethernet Interface	DB9 / M12
Product Dimension	Φ136×61.8
Product Weight	750g
Power Supply	DC12V (9~36V), PoE (802.3af)
Power	9W Max

Interface

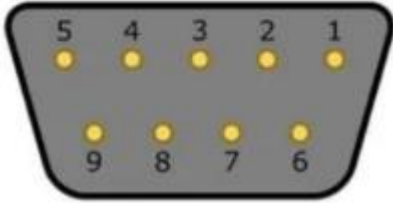
DB9: Ethernet+Power (PoE or independent power supply)		
1	RX+	
2	RX-	
3	NC	
4	TX+	
5	TX-	
6	NC	
7	NC	
8	DC12V+	
9	DC12V-	

DB9 (Female)

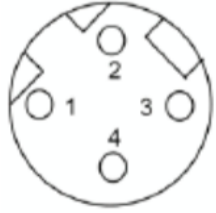
M12: Ethernet (PoE)		
1	TX+	 <p>D-code M12 (Female)</p>
2	RX+	
3	TX-	
4	RX-	

Dimension

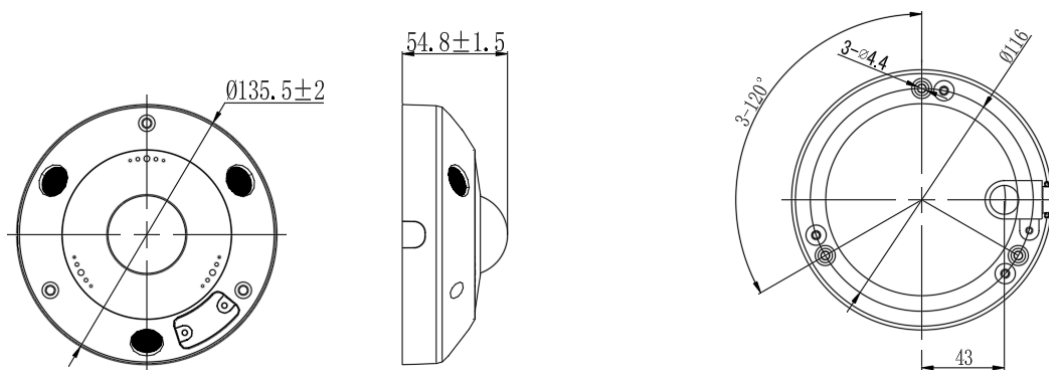

Without installation adapter plate (Unit: mm)

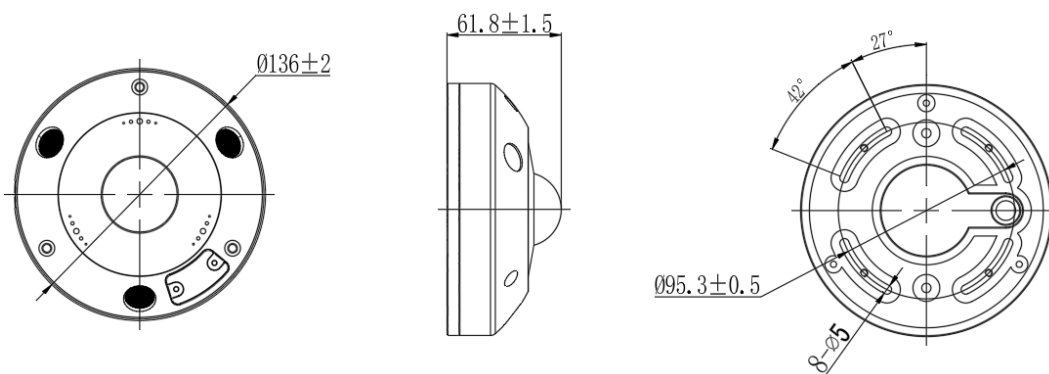

With installation adapter plate (Unit: mm)